

### KOSMOS builds a black calm island for airport lounge in russia

architecture 357 shares connections: +120

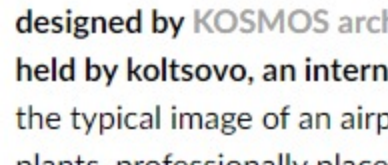

designed by KOSMOS architects in collaboration with dmitry potryasaev, the project is a result of a competition held by koltsovo, an international airport serving yekaterinburg, a city in the ural mountains, russia. aiming to avoid the typical image of an airport lounge, the design team has created a boundless black space enlivened by green plants, professionally placed lights, and a sophisticated selection of materials.



all photos by dmitry lyalin

in order to oppose the tendency of grey-beige hues in neutral, generic, and soft lounge areas, KOSMOS has designed a dark space with a completely relaxing atmosphere where the passengers can really detach themselves from the airport's crowds, noise, and rush, like in the painting of arnold böcklin, the team's reference, the idea was to create a dark, isolated island of total calm, filled with greenery.



the lounge is a dark room – completely painted in black and filled with plants, mirrors, and soft armchairs in the niches, the space allows tired passengers to fully relax and forget the hectic airport environment. just looking at the pictures, one can feel the moist fresh air the architects have brought into the room with the green palm trees and the oval granite bath of calm, still water.

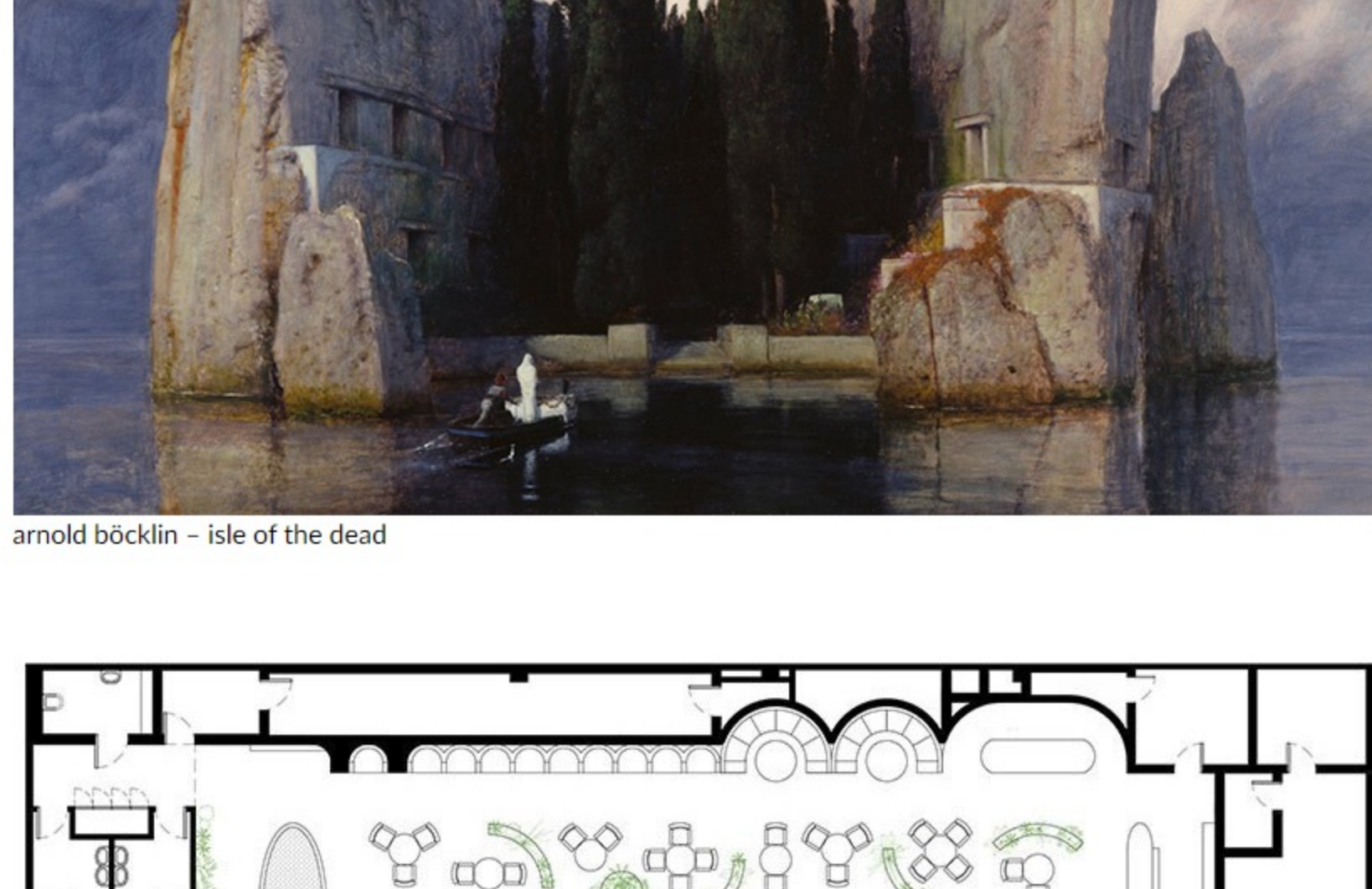

arnold böcklin – isle of the dead

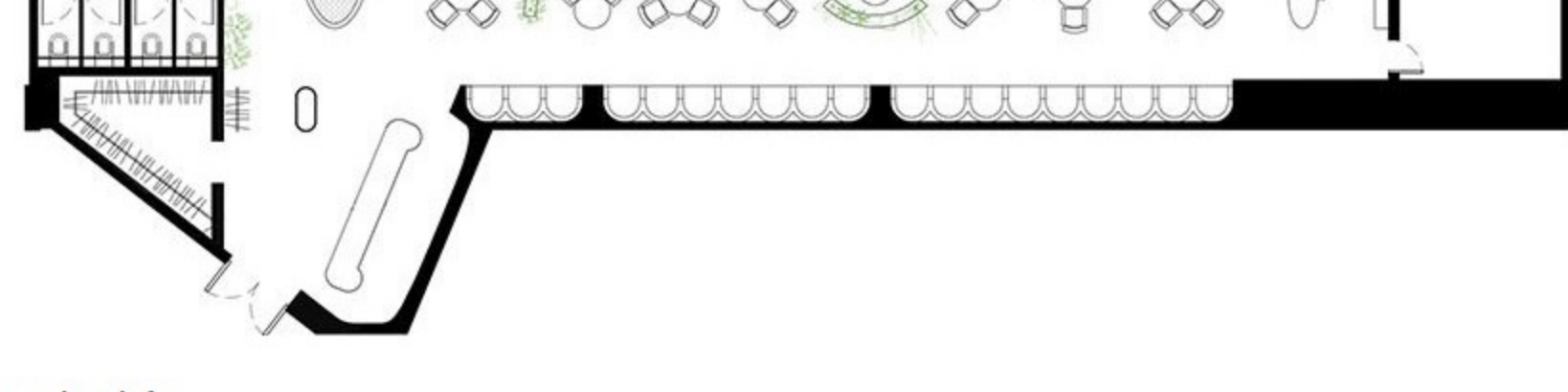

#### project info:

architects: KOSMOS architects, dmitry potryasaev  
location: koltsovo airport, yekaterinburg, russia  
greenery: ficus-design  
photography: dmitry lyalin